

PRAMOD JAINS
Himanshu GREENS
 GRAM KOTRA, MANDIDEEP - KOLAR ROAD
 COMMERCIAL & RESIDENTIAL PLOTS, SINGLEX & DUPLEX

HERE AT HIMANSHU GREENS, WE LEFT NO STONE UNTURNED TO BRING IN FUN-FILLED LIVING. JUST BE HERE, WHETHER YOU STAY AT HOME OR ROAM AROUND IN CAMPUS YOU WILL DISCOVER UNCOUNTABLE REASONS TO TAKE PLEASURE IN. EVERY SINGLE MOMENT YOU ARE GOING TO SPEND HERE WOULD BE FILLED WITH INCASSANT FESTIVITY.

PROJECT BENEFITS

HOSPITAL, SCHOOL, BUS STAND IN CLOSE VICINITY
 APPROACH ROAD TO KOLAR & RATANPUR.
 CLOSE TO MANDIDEEP RAILWAY STATION.
 COVERED CAMPUS WITH ALL AMENITIES.
 POLLUTION FREE ENVIRONMENT
 VASTU BASED LAYOUT

A PROJECT WHICH FULFILLS ALL THE MODERN WORLD NECESSITIES



PROJECT AMENITIES

| T. & C. P. APPROVED PROJECT | VASTU BASED LAYOUT PLANNING | FREE HOLD RESIDENTIAL PROPERTY
 | GRANDE ENTRANCE GATE WITH SECURITY ROOM | SECURED CAMPUS AND ROUND THE CLOCK SECURITY
 | A-CLASS DEVELOPMENT | IN-CAMPUS COMMERCIAL PLOTS | TAR ROAD | C.C. ROAD / PAVED BLOCKS
 | SEWAGE AND DRAINAGE LINE | HUGE OPEN AREA | ALL PLOTS ARE EAST / WEST FACING PLOTS
 | ELECTRIFICATION | WATER SUPPLY THROUGH SUMPWELL/OVER HEAD TANKS | LANDSCAPED GARDENS
 | ELEGANT STREET LIGHTING | POLLUTION FREE ENVIRONMENT | PARK | INSTANT LOAN FACILITY | FACILITY



Shri Parasnath
 BUILDERS & DEVELOPERS INDIA PVT. LTD.

TRUSTED GROUP FROM LAST 30 YEARS.

-: CONTACT DETAILS :-
 TEL. : 0755 4700410/11
 9826043891

PLOT NO. 5, 3rd FLOOR, BANK STREET, ZONE-2, M.P. NAGAR, BHOPAL - 482 011

SITE OFFICE :
 GRAM KOTRA, MANDIDEEP KOLAR ROAD, BHOPAL

THIS BROCHURE IS PURELY CONCEPTUAL & NOT A LEGAL OFFERING. ALL VISUAL PHOTOGRAPHS USED IN THIS BROCHURE ARE ARTISTS IMPRESSIONS. ALL SPECIFICATIONS, SIZES & LAYOUT ETC. ARE TENTATIVE & SUBJECT TO SUCH VARIATIONS, ADDITIONS, MODIFICATIONS AS DECIDED BY THE ARCHITECTS OR BY THE PROMOTERS.

PRAMOD JAINS
Himanshu GREENS
 GRAM KOTRA, MANDIDEEP - KOLAR ROAD
 COMMERCIAL & RESIDENTIAL PLOTS, SINGLEX & DUPLEX

RIGHT INVESTMENT AT THE RIGHT TIME

SECURED INVESTMENT MAXIMUM BENEFITS



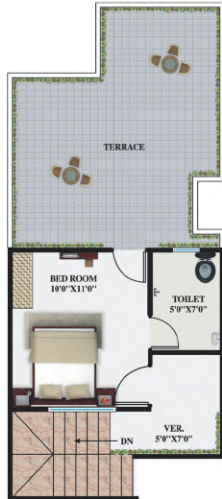
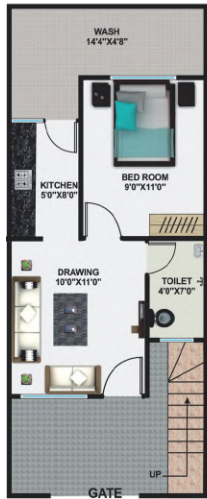

SINGLE FLOOR PLAN
PLOT SIZE - 15'0" X 35'0"
PLOT AREA - 525.00 SQ.FT.

DUPLEX FLOOR PLAN
PLOT SIZE - 16'0" X 35'0"
PLOT AREA - 560.00 SQ.FT.

- EASY LOAN FACILITY
- QUICK REGISTRY
- ALL GOVT. PERMISSIONS APPROVED PHASE 1



LAYOUT PLAN



A VARIETY OF OFFERINGS
FOR A VARIETY OF CHOICES

PHASE 1



APPROVED COLONY HIMANSHU GREENS PHASE 2

COLOR LEGEND PHSE - 2

- 6.10 X 15.24 SQ. MTR - 20 X 50 SQ. FT.
- 6.10 X 10.67 SQ. MTR - 20 X 35 SQ. FT.
- IRREGULAR
- E.W.S PLOTS
- 6.10 X 12.20 SQ. MTR - 20 X 40 SQ. FT.
- 5.48 X 12.20 SQ. MTR - 18 X 40 SQ. FT.
- L.I.G PLOTS
- 20 X 30 sq. ft.
- 18 X 40 sq. ft.
- 15 X 35 sq. ft.
- 16 X 35 sq. ft.

